

Kimberley Riverside Campground – Trailer Rental Information 2018 Campsite #81

Cherokee 274-DBH Sleeps 7-8 people

Features:

- ✓ Queen Bed
- ✓ Double size Bunk Beds (top bunk weight limit of 225lbs)
- ✓ Tub, Shower, Sink & Toilet with outside access door.
- ✓ Interior kitchen with refrigerator, Stove, Microwave and an outdoor ice maker with mini-fridge.
- ✓ Hard bedroom doors for added privacy
- ✓ Fireplace and Air Conditioner for comfort
- ✓ Blue LED lighting and USB Ports throughout
- ✓ 15' Electric Awning with LED strip lighting
- ✓ U-Shape Dinette with separate sofa seating, both convert to beds
- ✓ DVD Player & TV (no cable/satellite)
- ✓ Outdoor Shower with hot/cold
- ✓ Parking for 1 vehicle
- ✓ **Overlooking the Stunning St. Mary River**
- ✓ **Bonus!** Unlimited Putting Course wristband pass for each person

Included:

- ✓ All Campsite amenities – no hidden charges!
- ✓ Propane tank (for RV use only) to run the heater, fridge and cooker
- ✓ BBQ Grill (1lb propane tanks not included)
- ✓ Linens
 - Queen Bed Set, 2 single sleeping bags and 4 pillows, 4 Bath Towels, 4 face cloths included as standard.
 - Additional Linen sets are included in the additional person rates (detailed in the chart below).
 - Tea Towel and Dish Cloths
 - SAVE \$30/stay by bringing your own bedding & towels!
- ✓ Outdoor Mat
- ✓ Picnic Table with table cloth & clamps
- ✓ Firepit (not available for use during a fireban – an approved propane firepit may be available for rental during fireban – subject to availability).
- ✓ 2 Outdoor clothing drying rack
- ✓ 4 Camping Chairs
- ✓ Garbage Can & Recycling bin inside and outside
- ✓ Toaster, Kettle and coffee Maker (coffee and tea not supplied)
- ✓ Dining Set for 8 People and colored children dishes
- ✓ Crockery & Cooking Utensils (Pots, Pans, Knives, Cutting Boards, utensils)
- ✓ All Cleaning Supplies
- ✓ A small selection of DVDs and Board/Card Games
- ✓ You may borrow sports equipment from the office: Bocce, Horseshoes, Volleyball, Basketball, Soccer ball, Football, Frisbees, Tic-Tac-Toe.

You need to bring:

- Toiletries
- Food & Drinks
- Beach Towels & Swimwear
- Clothing and any personal items.
- Lantern/Flashlight & Batteries
- Small 1lb propane tanks if you plan on utilising the outdoor Grill/BBQ
- Firewood is not included and may be purchased in the office.
- If you have any item you simply can't live without, bring it!
- *If there is anything you are not sure of, please call the campground office to confirm: 250 427 2929 or 1 877 999 2929*

Notes about the campsite:

- ✓ RV Pad is located across from additional flush toilets, free hot showers and the Wi-Fi hotspot
- ✓ Cell phone service is spotty and there is no guarantee you will receive Wi-Fi or Cell service inside the trailer, although majority of guests can receive both wifi and cell service at Site 81.
- ✓ You will have access to: Free hot showers, Free Wi-Fi Hotspots, free swimming pool (Mid June to first week of Sept) and will receive an unlimited putting course wristband for each person booked (the course is open Early May through late Sept).
- ✓ Sorry, Pets are **not** permitted in the rental trailer.
- ✓ Be Animal Aware! All garbage and recycling must be properly disposed of each day. Garbage and Recycling facilities are located at the washroom building. Please fully clean BBQ grill after each use to prevent wildlife (big and small).
- ✓ Please note that the RV may not be suitable for infants or toddlers as it is not "baby proofed". Infant Cribs are not available.
- ✓ Housekeeping services are **not** provided during your stay.
- ✓ If you have more than 1 vehicle and it doesn't fit on the gravel pad of your campsite, you must park it in guest parking near the campground office.

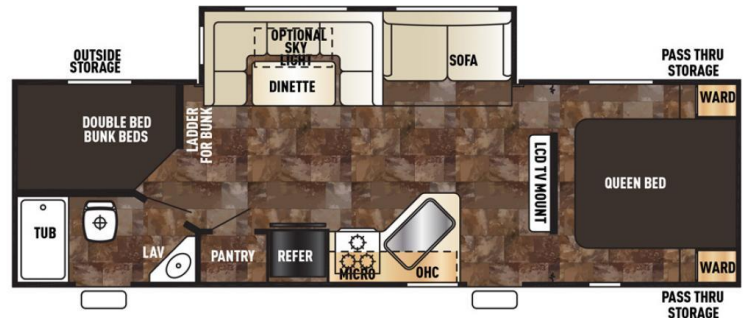

Rates: **Receive 15% off your stay when you book for 7 or more nights!**
Save \$30.00/stay when you bring your own bedding & towels – please let us know when you reserve!
 5% GST not included in rates below.

Number Of People	Early Spring Opening to Apr 30	Spring May 1 to June 15	Peak June 16 to Sept 14	Fall Sept 15 to Sept 30	Late Fall Oct 1 to Closing
1 to 4 People	\$149.00/night \$906.96/week	\$164.00/night \$998.26/week	\$189.00/night \$1150.43/week	\$164.00/night \$998.26/week	\$149.00/night \$906.96/week
Each Additional Person <i>(aged 3 and up)</i>	\$10.00 per stay Includes 1 of each: Sleeping Bag & Pillow, Towel & Face Cloth	\$15.00 per stay Includes 1 of each: Sleeping Bag & Pillow, Towel & Face Cloth, Unlimited Mini Golf	\$15.00 per stay Includes 1 of each: Sleeping Bag & Pillow, Towel & Face Cloth, Unlimited Mini Golf	\$15.00 per stay Includes 1 of each: Sleeping Bag & Pillow, Towel & Face Cloth, Unlimited Mini Golf	\$10.00 per stay Includes 1 of each: Sleeping Bag & Pillow, Towel & Face Cloth,

Kimberley Riverside Campground – Trailer Rental Policies

- A 3-night minimum is required
- In order to reserve you must be 25 years old and have a valid credit card, with room for a \$400 security deposit upon check-in.
- A 1-night *partially refundable* deposit is required upon booking.
- Cancellation within 3 weeks of arrival will forfeit your entire 1-night deposit, no refunds, no exceptions.
- Cancellation with more than 3 weeks notice prior to your arrival will forfeit 50% of your deposit (you will only be refunded 50%, the other 50% is kept by the campground and covers our lost revenues and administration fees)
- Late Arrivals and/or Early Departures that we are informed of within 3 weeks of your arrival are your responsibility and you will be charged the original booking costs. You will be only be refunded 50% for the nights we can fill. If we are unable to fill the nights, you will not be refunded.
- If you need to amend your dates and have given us more than 3 weeks notice, no additional penalty will be applied, unless you shorten it to less than 3 nights which is our minimum number of nights required.

Upon check-in you will be charged a \$400 security deposit onto a valid visa or Mastercard. You will be refunded the security deposit within 3 days of check-out, less any cleaning fees or replacement costs if applicable.

Check In	3pm until the office closes (inquire with the office for office hours)
Check Out	11am at the latest. Unauthorised late check out will incur additional night charges.
Quiet Time	Strictly from 11pm to 8am
No Pets Allowed	a \$250 charge will be incurred if this policy is violated.
No Smoking Allowed	a \$400 charge will be incurred if this policy is violated.
Keys	a \$30 charge will be incurred for lost keys
Cleaning Fee	a \$75/30min charge will be incurred if the RV if left a mess or if any garbage or recycling is left behind.

You will not receive housekeeping services during your stay. It is your responsibility to ensure that the trailer is left in a gently used and condition upon check-out. We will launder all the linens and bedding, clean the RV and will remove any burned firewood upon your check-out. Please ensure that all dishes are washed/put away and any garbage/recycling is put in the dumpster/recycling bins nightly (to prevent bears) and also disposed of before your departure.

Upon check in you will receive a map with information on our amenities. Once you are checked in, please refer to the information binder located inside the RV unit for information and a full a list of contents & inventory. Please ensure the inventory & contents list is accurate upon check-in. Any missing or damaged contents will be charged to you upon your check-out.

